

PIBBS INDUSTRIES INSTRUCTION FOR MOUNTING CHAIR ON PUMP

*MAKE SURE SLOT FOR PIN
ON SEAT BRACKET IS
FACING FRONT OF CHAIR*

*PLACE CHAIR ON TOP OF
PUMP MAKING SURE SLOT
ON SEAT BRACKET AND PIN
LINE UP, CHAIR WILL BE AIR
SEALED AND NO TOOLS
WILL BE NEEDED TO
SECURE*

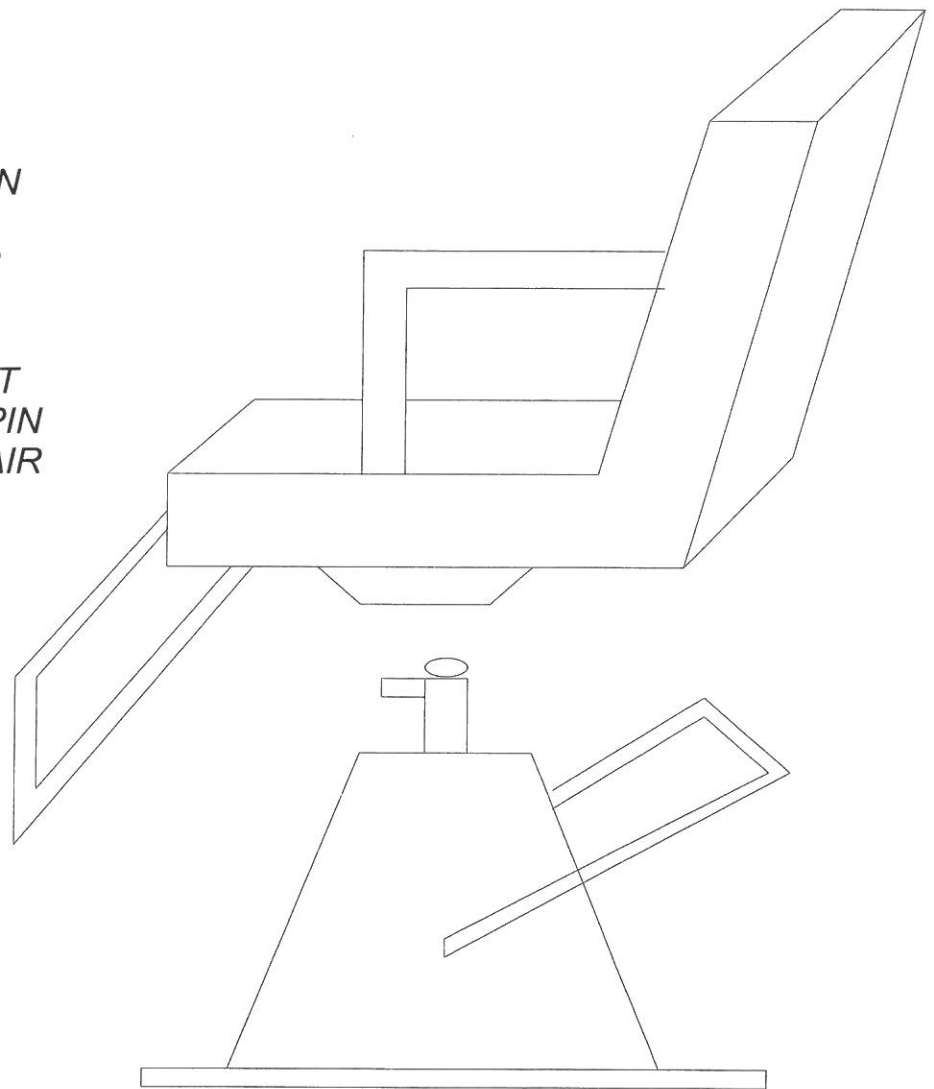

FOOTREST ASSEMBLY



133 -15 32nd Ave.
Flushing, NY 11354
(718) 445-8046
(800) 551-5020
Fax (718) 461-3910

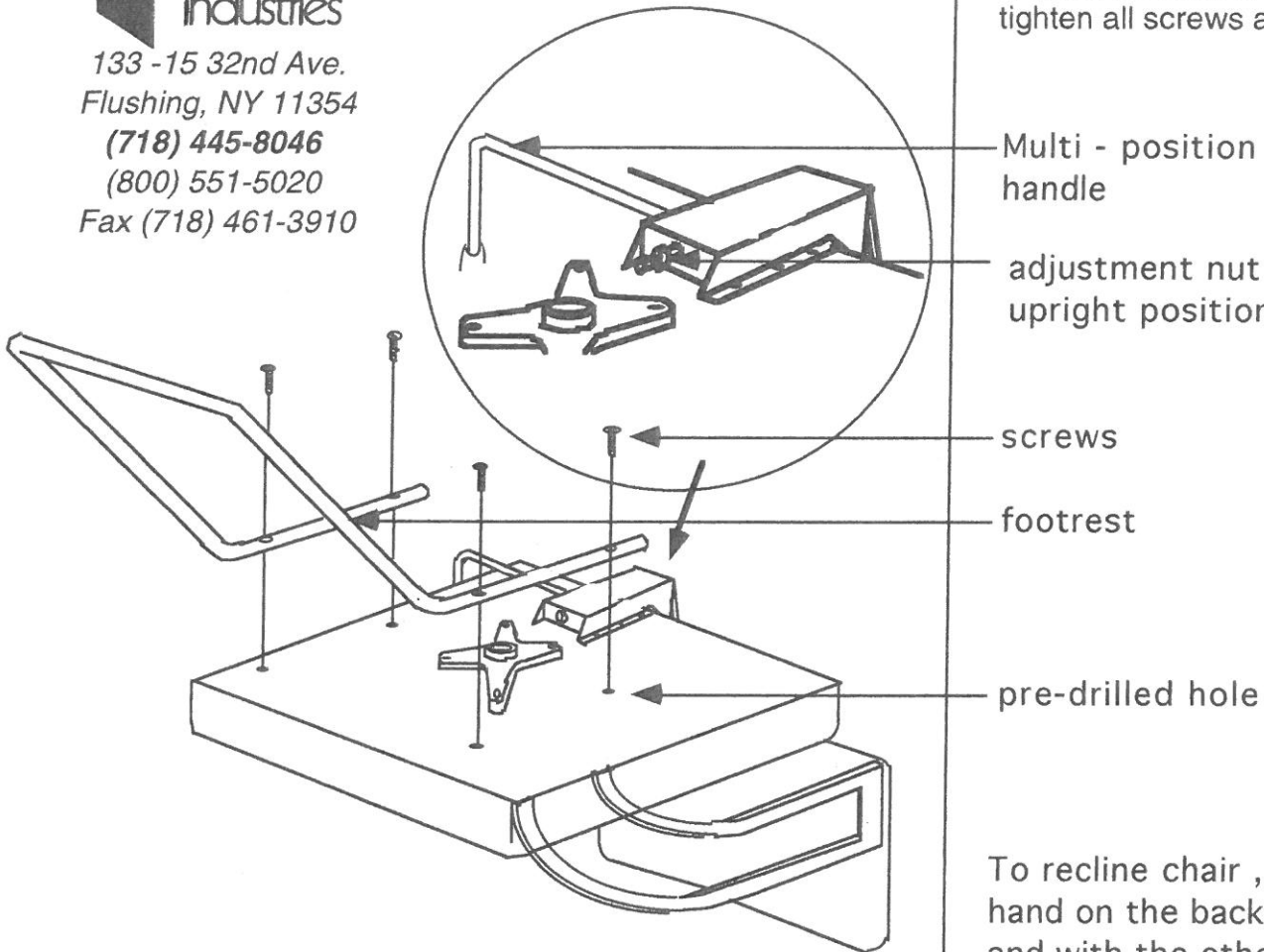

Locate the 4 pre-drilled holes underneath the seat. Align the holes in the footrest to the pre-drilled holes in the seat. Use the enclosed screws to secure the footrest to the seat. *Please be sure to periodically tighten all screws and bolts.

Multi - position adjustment handle

adjustment nut - for the upright position

screws

footrest

pre-drilled hole

To recline chair , place one hand on the back of the chair and with the other hand, push the lever forward. This will allow the back to re - cline freely.

FOOTREST ASSEMBLY



133 -15 32nd Ave.
Flushing, NY 11354
(718) 445-8046
(800) 551-5020
Fax (718) 461-3910

Locate the 4 pre-drilled holes underneath the seat. Align the holes in the footrest to the pre-drilled holes in the seat. Use the enclosed screws to secure the footrest to the seat

*Please note that screws should be retightened as needed.

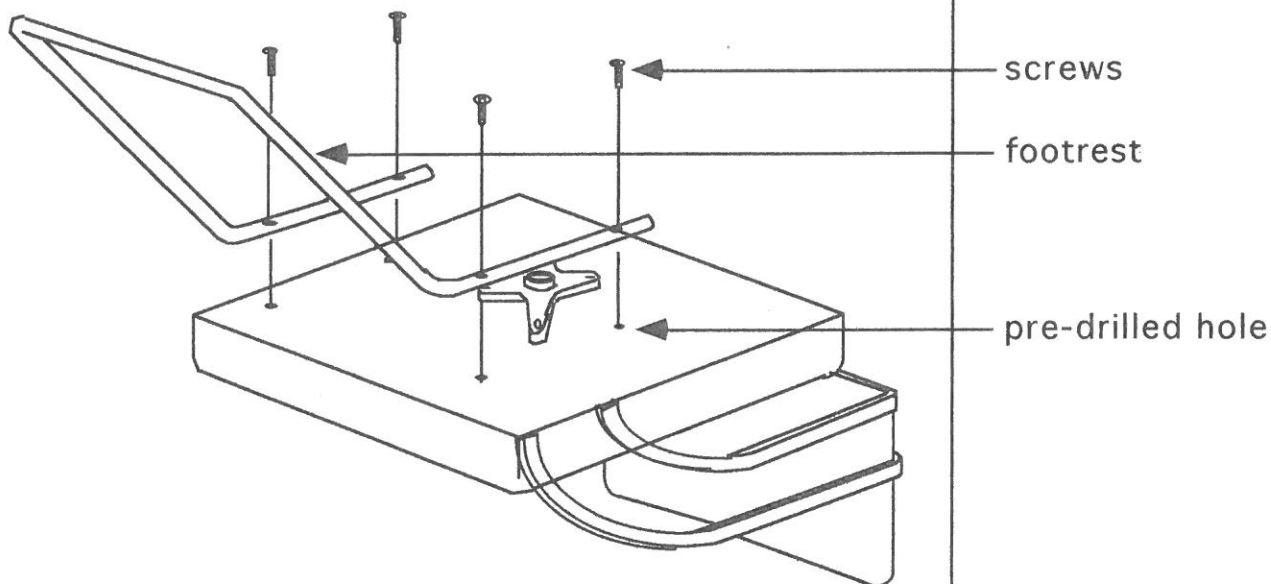

Pibbs industries reserves the right to modify deign at any time.

Pibbs Industries 133-15 32nd Ave., Flushing, NY 11354 (718)445-8046

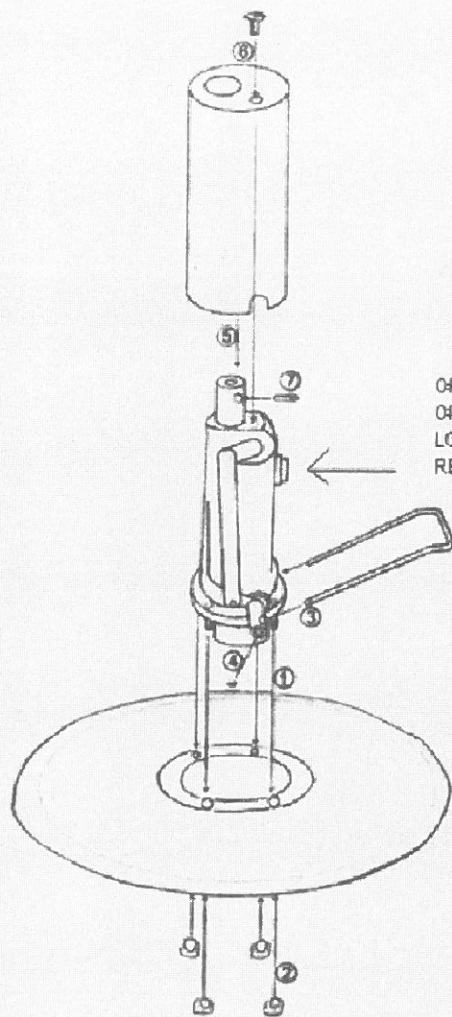

OPEN TO PUT HYDRAULIC OIL, ALSO IF PUMP IS LOCKED, OPEN TO RELEASE AIR LOCK

- 1) 4 SCREWS CONNECT BASE TO PUMP
- 2) FASTEN NUTS TO SCREWS
- 3) FASTEN PEDAL TO PUMP
- 4) PLACE CHROME COVER ON PUMP
- 5) SECURE COVER TO PUMP WITH SCREW
- 6) INSERT PIN IN SHAFT HOLE
- 7) Check all screws every 3 months.

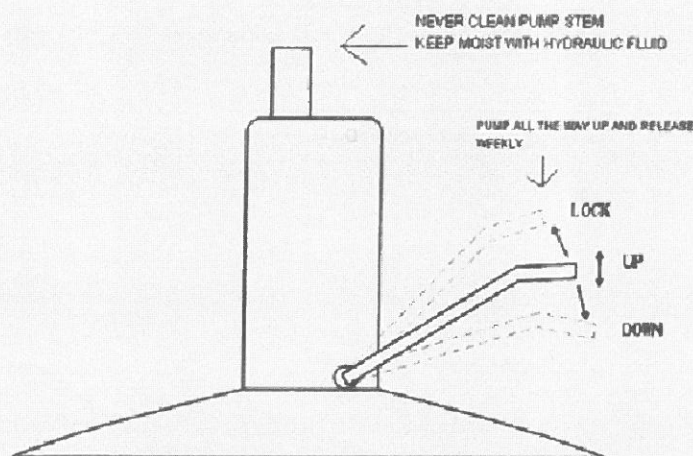

- 1) STEP ON PUMP PEDAL LIGHTLY, TO RAISE.
- 2) LIFT PUMP PEDAL IN THE UP POSITION TO LOCK CHAIR
- 3) PUSH PUMP PEDAL DOWN, TO MAKE CHAIR GO DOWN
- 4) IF RETURNING PUMP FOR SERVICE, SEND PUMP MECHANISM ONLY, NEVER SEND BASE PLATE OR PUMP COVER TO MANUFACTURER.
- 5) IF PUMP IS MAKING NOISE WHEN GOING UP OR DOWN, ADJUST PUMP COVER SO IT DOES NOT TOUCH PUMP STEM

WARNING - DO NOT STAND ON PEDAL

1606 PUMP INSTRUCTIONS FOR ADJUSTING BRAKE TENSION

TO TIGHTEN BRAKE
TURN INSIDE NUT
CLOCKWISE AND TO
LOOSEN TURN
COUNTER
CLOCKWISE

LOOSEN OUTSIDE
NUT BEFORE
ADJUSTING INSIDE
NUT, TIGHTEN
OUTSIDE NUT AFTER
ADJUSTMENT IS
DONE TO INSIDE NUT
WHEN TIGHTENING
OUTSIDE NUT, MAKE
SURE INSIDE NUT IS
SECURED AND DOES
NOT TURN

